

Kütük Tip Ard Germe Grubu Flat Block Type Post Tension Group

FLB

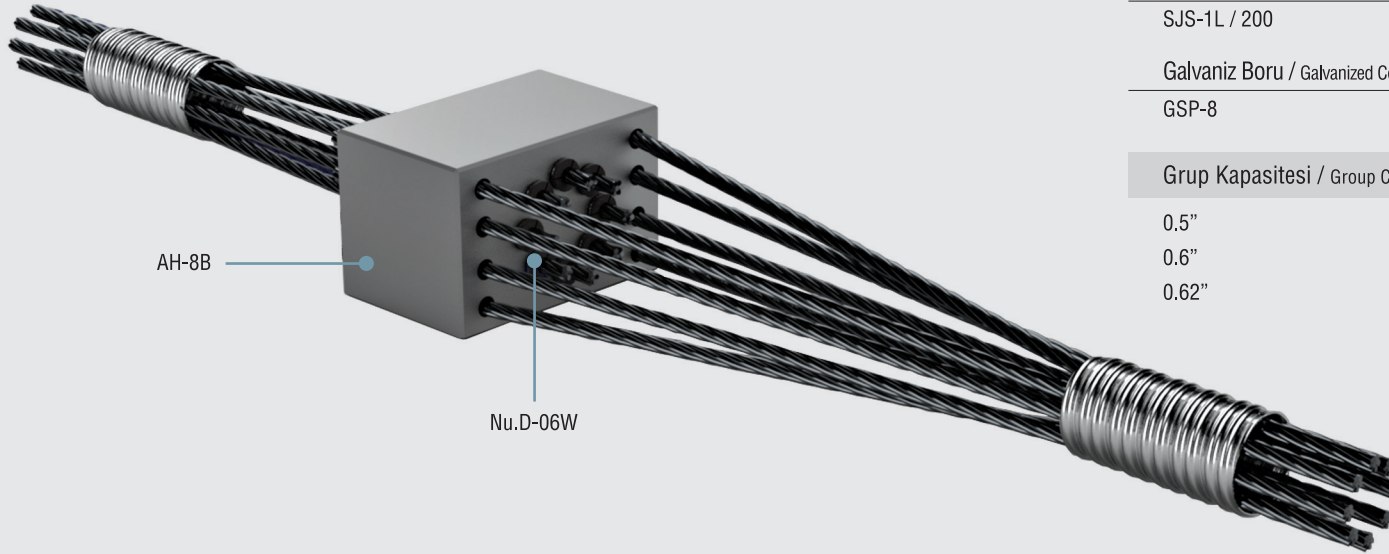

FLB-8/06 Set

Germe Krikosu / Stressing Jack (i) Sayfa / Page

SJS-1L / 200 37

Galvaniz Boru / Galvanized Corrugated Duct (i) Sayfa / Page

GSP-8 38

Grup Kapasitesi / Group Capacity

0.5" 2070 kN

0.6" 2484 kN

0.62" 2565 kN

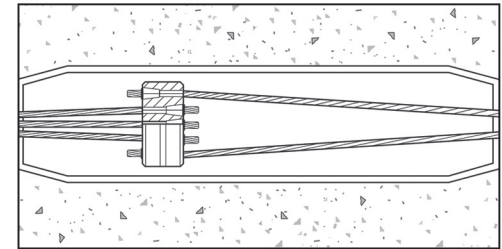
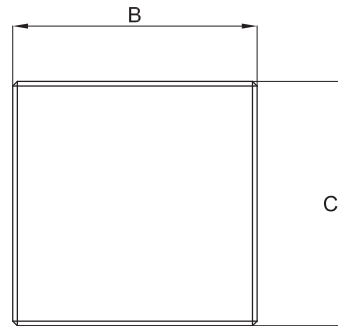
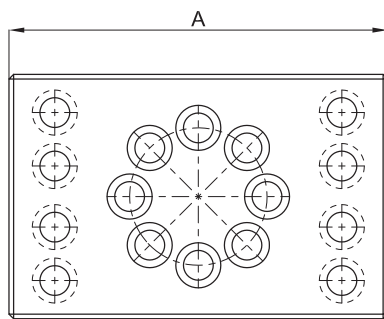

| Model No. | | FLB-4/05 | FLB-6/05 | FLB-8/05 | FLB-4/06 | FLB-6/06 | FLB-8/06 | FLB-4/062 | FLB-6/062 | FLB-8/062 |
|-----------|----|----------|----------|----------|----------|----------|----------|-----------|-----------|-----------|
| A | mm | 170 | 210 | 270 | 170 | 210 | 270 | 170 | 210 | 275 |
| B | mm | 80 | 100 | 130 | 80 | 100 | 130 | 80 | 100 | 135 |
| C | mm | 100 | 140 | 150 | 100 | 140 | 150 | 100 | 140 | 155 |